

Replacing the Lamp

The projector automatically detects the lamp life. When the lamp is nearing the end of life, a warning is displayed on the screen.

When the warning appears, contact Mimio Customer Support to order a replacement lamp as soon as possible. Make sure the projector is off and has cooled down for at least 60 minutes before changing the lamp.

Notes

- The screws on the lamp cover and the lamp cannot be removed.
- The projector cannot be turned on while the lamp cover is removed.
- Do not touch the glass area of the lamp. Oils from your skin can cause the lamp to shatter. Use a dry cloth to clean the lamp module if the lamp is accidentally touched.

To remove the lamp module

1. Press the power button to turn off the projector.
2. Allow the projector to cool down for at least 60 minutes.
3. Unplug the power cord.
4. Using a screwdriver, loosen the two screws on the lamp cover.
5. Lift and remove the lamp cover.
6. Using a screwdriver, loosen the two screws on the lamp module.
7. Pull the lamp handle up and slowly and carefully remove the lamp module.

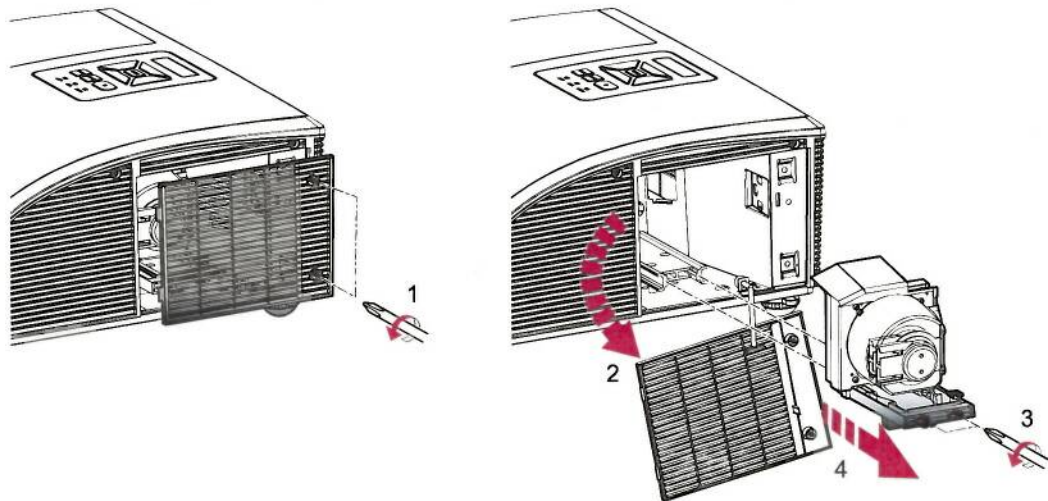

To insert the new lamp module

1. Slowly and carefully insert the lamp module into the lamp compartment and push the lamp handle down.
2. Using a screwdriver, tighten the two screws on the lamp module.
3. Replace the lamp cover.
4. Using a screwdriver, tighten the two screws on the lamp cover.
5. Plug the power cord into a wall outlet.